

Nomenclature (example for part # VRM3-12.5-T-PL)

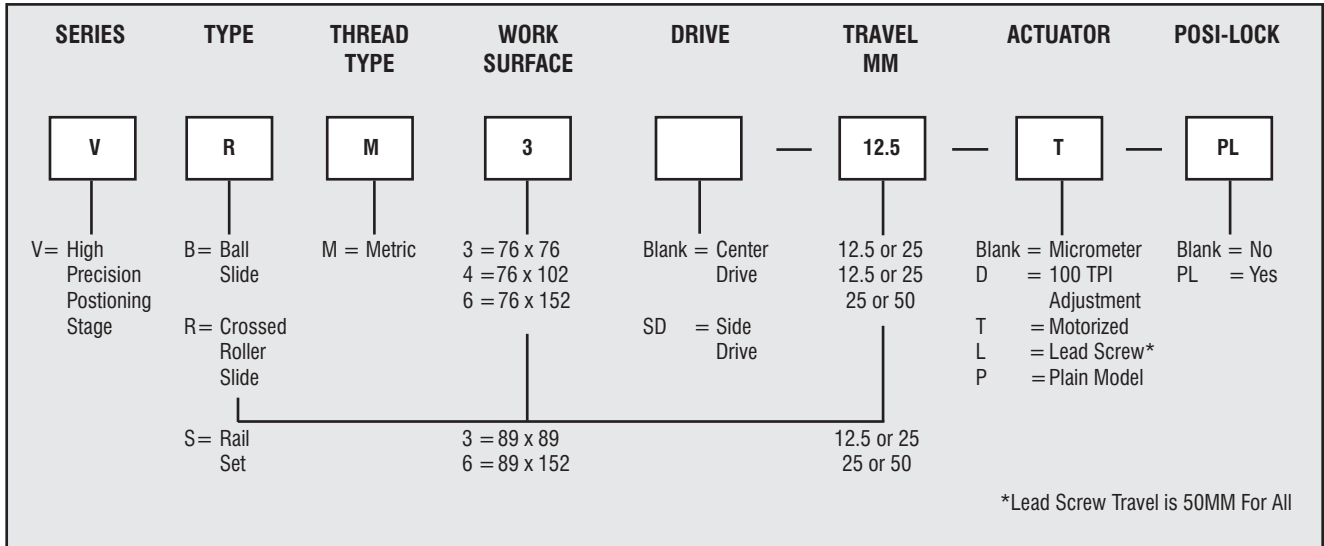

Ball or Crossed Roller - METRIC

VBM3-P, VRM3-P

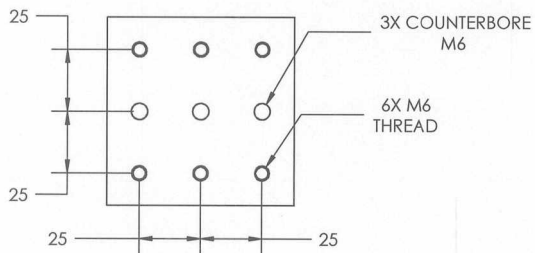
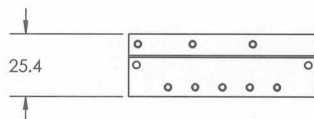
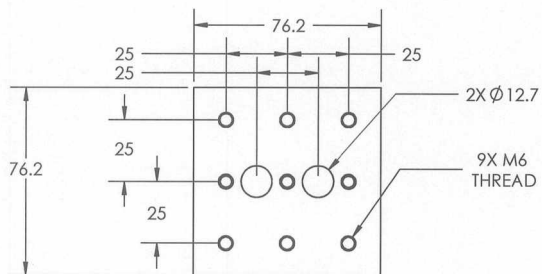

VBM3/VRM3-PL
POSI-LOCK FEATURE CAN BE
ADDED TO EITHER SIDE

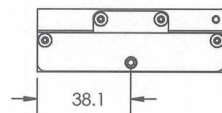
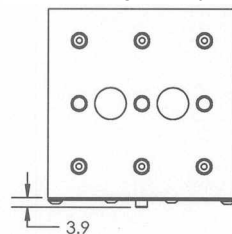

Ball or Crossed Roller - METRIC

VBM4-P, VRM4-P

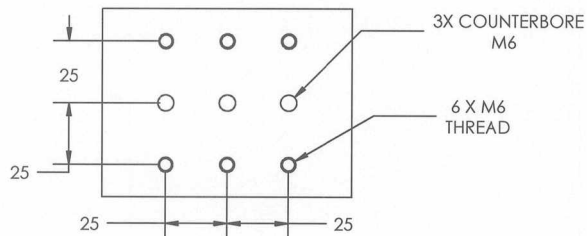
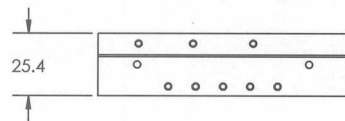
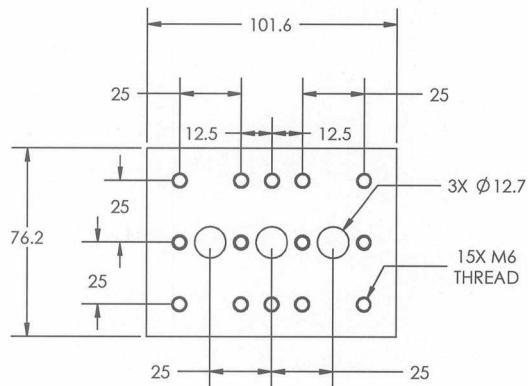

VBM4/VRM4-PL
POSI-LOCK FEATURE CAN BE
ADDED TO EITHER SIDE

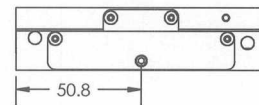
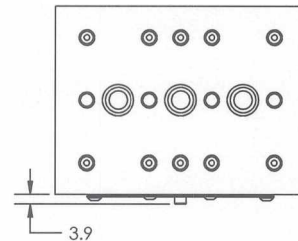

Ball or Crossed Roller - METRIC

VBM6-P, VRM6-P

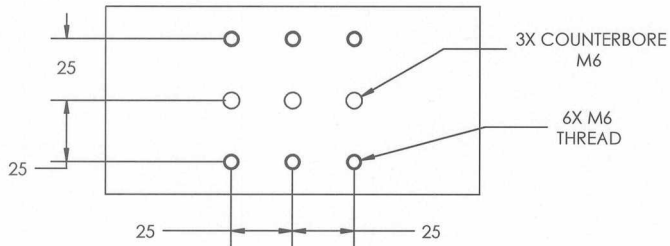
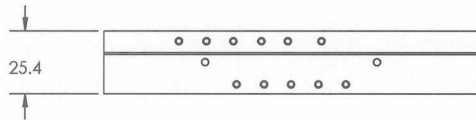
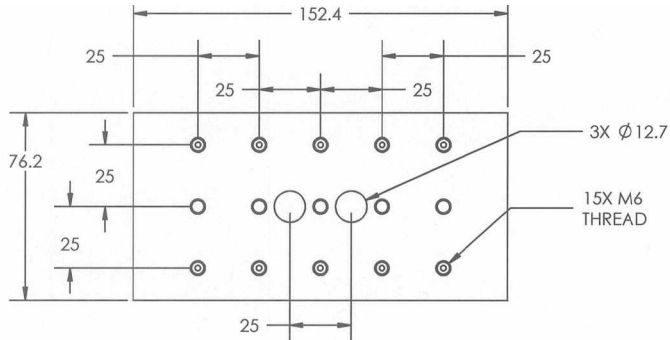

VBM6/VRM6-PL
POSI-LOCK FEATURE CAN BE
ADDED TO EITHER SIDE

